

OPEN MARKET CONSULTATION

Germany, Mülheim an der Ruhr
Focus target group: Suppliers

Programme

Time	Agenda Title
09:30-10:00	Registration and Welcome Coffee
10:00-10:15	Project Goals and Achievements and Planning
10:15-10:30	EU Innovation public demand Policy
10:30-11:00	STARS' Common Innovation need
11:00-11:15	Break (coffee, refreshments)
11:15-12:45	Technical Dialogue with the market
12:45-13:00	Final Remarks
13:00-14:00	Lunch
13:00-15:00	Networking Opportunities Session (Opportunity to find partners with complementary skills)

→ WHEN & WHERE

24.01.2018

9:30-15:00

ZENIT GmbH / Bismarckstraße 28 /
45470 Mülheim an der Ruhr/ Germany

→ REGISTER AT

info@stars-pcp.eu

Das Projekt Horizon 2020 "Empowering patients by professional STress Avoidance and Recovery Services" (STARS) wurde im Januar 2017 gestartet und hat eine Laufzeit von 48 Monaten. Der Zweck der vorkommerziellen Auftragsvergabe von STARS ist es, eine neue Technologie zu entwerfen, zu prototypisieren und zu testen, um Stress und Ängste von chirurgischen Patienten während des Pflegeprozesses zu reduzieren und eine aktive Rolle des Patienten und des Pflegepersonals im Gesundheitsmanagement in den folgenden Phasen zu fördern: präklinisch, klinisch und postklinisch. STARS ist ein von der Europäischen Gemeinschaft finanziertes PCP-Projekt (Pre-Commercial Procurement), das von der Universität Maastricht (Niederlande) koordiniert wird, an dem 10 weitere europäische Partner beteiligt sind.

PCP eHealth Innovation in Empowering the patient

11-02-2016

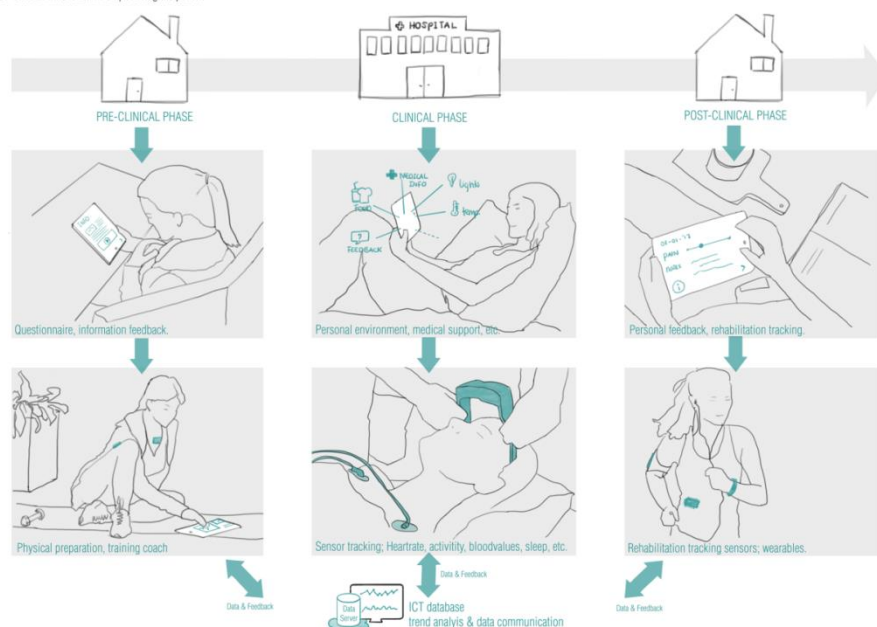

General technical skills and expertise of participating supplier's shall include

- ✓ Hardware & Software development
- ✓ Wearables
- ✓ Creating new databases, enabling big-data analysis, multivariate data processing
- ✓ Interface design
- ✓ ICT environmental skills

This project has received funding from the European Union's Horizon 2020 research and innovation programme

European Commission



How to find the event location

ZENIT GmbH / Bismarckstraße 28 /

45470 Mülheim an der Ruhr / Germany

Arriving by car

From Dortmund/Essen:

Leave the A40 at the Mülheim-Zentrum/Heißen-Kirche exit and continue on the B1 in the direction of Düsseldorf (about 4 km). Approximately 150 m after an ARAL petrol station on the left side you leave the B1 which turns left here and continue straight into Bismarckstraße. You will reach ZENIT which is situated on the left side of the street after a few hundred meters. Parking spaces are found mainly in the streets on the opposite side and around the sports court.

From Cologne/Düsseldorf:

Follow the A3/A52 to the Breitscheid interchange. If coming from Cologne, change onto the A52 towards Essen. Take the exit in the direction of "Rat.-Breitscheid/Mülheim an der Ruhr" which leads immediately off this interchange. Turn left at the traffic lights towards Mülheim. Follow the B1 for about 7 km in the direction of Mülheim/Essen until you cross the River Ruhr. Turn left after about 1 km into Bismarckstraße. You will reach ZENIT which is situated on the left side of the street after a few hundred meters. Parking spaces are found mainly in the streets on the opposite side and around the sports court.

Arriving by public transport

From Mülheim Central Railway Station (Hauptbahnhof) take the metro 102 or 901 to "Stadtmitte" (city centre) and continue with tram 104 (runs every 20 minutes) in the direction of (Hauptfriedhof) to the stop "Max-Planck-Institute. ZENIT is situated only a few meters from there.

On foot (about 25 minutes)

Leave Mülheim Central Railway Station and walk through the adjacent shopping centre ("Forum") in the direction of Kaiserstraße. Continue on Kaiserstraße until you reach a small park on the right. Walk through the park and you will reach a street called Kluse. Follow this street, turn left into Lembkestraße, where the Max Planck Institute is situated. Follow the street until you reach Bismarckstraße. Turn right into Bismarckstraße and you will reach ZENIT after a few meters.

Arriving by aeroplane

From Düsseldorf Airport take the train to Mülheim Central Railway Station or the "S Bahn"-train S1 train in the direction of Dortmund to Mülheim Central Railway Station (Hauptbahnhof). Continue from Mülheim Central Railway Station as described above.

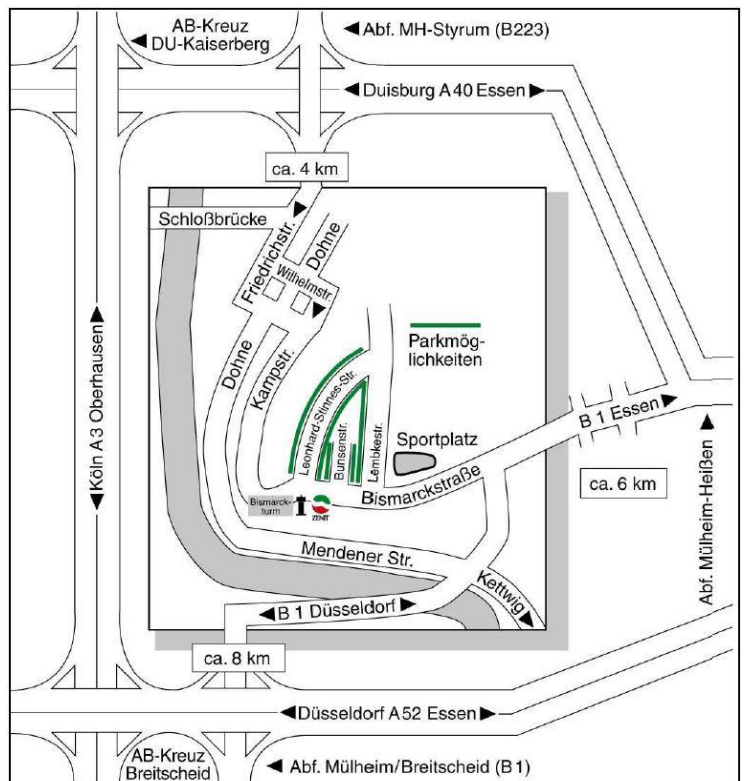

Hotels in Mülheim an der Ruhr

near the event location

Hotel Noy

Hotel Noy
Schloßstraße 28-30
45468 Mülheim an der Ruhr
Phone: +49 (0)208 - 4505-0
Fax: +49 (0)208 - 4505-300
www.hotelnoy.de
info@hotelnoy.de

Hotel Handelshof

Hotel Handelshof
Friedrichstraße 15-19
45468 Mülheim an der Ruhr
Phone: +49 208 3088 0
Fax +49 208 3088 488
info@handelshof-hotel.de
www.handelshof-hotel.de

B&B Hotel

B&B Hotel Mülheim
Tourainer Ring 31
45468 Mülheim an der Ruhr
Phone: +49 (0) 208 377 80 0
Fax: +49 (0) 208 377 80 444
<https://www.hotelbb.de/en/muelheim-der-ruhr/overview>
muelheim-an-der-ruhr@hotelbb.com

Hotel "Am Schloß Broich"

Hotel am Schloss Broich
Am Schloss Broich 27
45479 Mülheim an der Ruhr
Phone: +49 208/993080
Fax: +49 208/9930850
Mail@hotel-broich.com
<http://www.hotel-broich.com/>

BEST WESTERN Hotel

Hans – Böckler – Platz 19
45468 Mülheim an der Ruhr
Phone: +49 208–30 86 30
Fax: +49 208–3086 3113
info@hotelimforum.de
www.hotelimforum.de

Hotel am Ruhrufer

Hotel am Ruhrufer
Dohne 74
45468 Mülheim an der Ruhr
Phone: +49 208 991850
Fax: +49 208 9918599
www.hotel-am-ruhrufer.de
info@hotel-am-ruhrufer.de

Hotel Thiesmann

Hotel Thiesmann
Dimbeck 56
45470 Mülheim an der Ruhr
Telefon: 0208 / 3068 90
Telefax: 0208 / 3068 990
E-Mail:info@hotel-thiesmann.de

